



# INSTRUCTION BULLETIN

No. 9010967  
Machine: T12  
Published: 04-2013  
Rev. 00

**NOTE: DO NOT DISCARD the Parts List from the Instruction Bulletin. Place the Parts List in the appropriate place in the machine manual for future reference. Retaining the Parts List will make it easier to reorder individual parts and will save the cost of ordering an entire kit.**

*NOTE: Numbers in parenthesis ( ) are reference numbers for parts listed in Bill of Materials.*

Installation instructions for **kit number 9010937**

## SYNOPSIS:

This kit contains the parts needed to replace the rear squeegee rod assembly on T12 scrubbers. Please follow step-by-step instructions.

## SPECIAL TOOLS / CONSIDERATIONS: NONE

(Estimated time to complete: 45 minutes)



### PROTECT THE ENVIRONMENT

Please dispose of packaging materials, old machine components, and hazardous fluids in an environmentally safe manner according to local waste disposal regulations.

Always remember to recycle.

## PREPARATION:

1. Park the machine on a clean level surface, completely lower the rear squeegee, turn off the machine, and remove the key.

**FOR SAFETY: Before leaving or servicing machine, stop on level surface, turn off machine, and remove key.**

2. Disconnect the vacuum hose from the rear squeegee.

## INSTALLATION:

1. Remove the squeegee rod assembly from the machine. Discard the squeegee rod assembly and mounting hardware. (Fig. 1)
2. Adjust the new squeegee rod assembly (1). Turn the rod end located closest to the adjustment knobs into (clockwise) the squeegee rod assembly and then turn the rod end nine turns out (counterclockwise) from the squeegee rod assembly. (Fig. 1)

3. Loosen the squeegee rod assembly lock knob and then hand tighten the adjustment knob completely in. (Fig. 1)
4. Use a M10 hex nut (3) and a flat washer (2) to install the squeegee rod assembly (1) onto the rear axle assembly. (Fig. 1)
5. Use a M10 hex nut (3) and a flat washer (2) to install the squeegee rod assembly (1) onto the squeegee lift arm assembly. (Fig. 1)
6. Reconnect the vacuum hose to the rear squeegee.
7. Level the rear squeegee blade and adjust the rear squeegee blade deflection. Refer **ADJUSTING THE REAR SQUEEGEE DEFLECTION** and **LEVELING THE REAR SQUEEGEE** in the **MAINTENANCE** section of the Operator Manual for instructions how to level the rear squeegee and adjust the rear squeegee blade deflection.

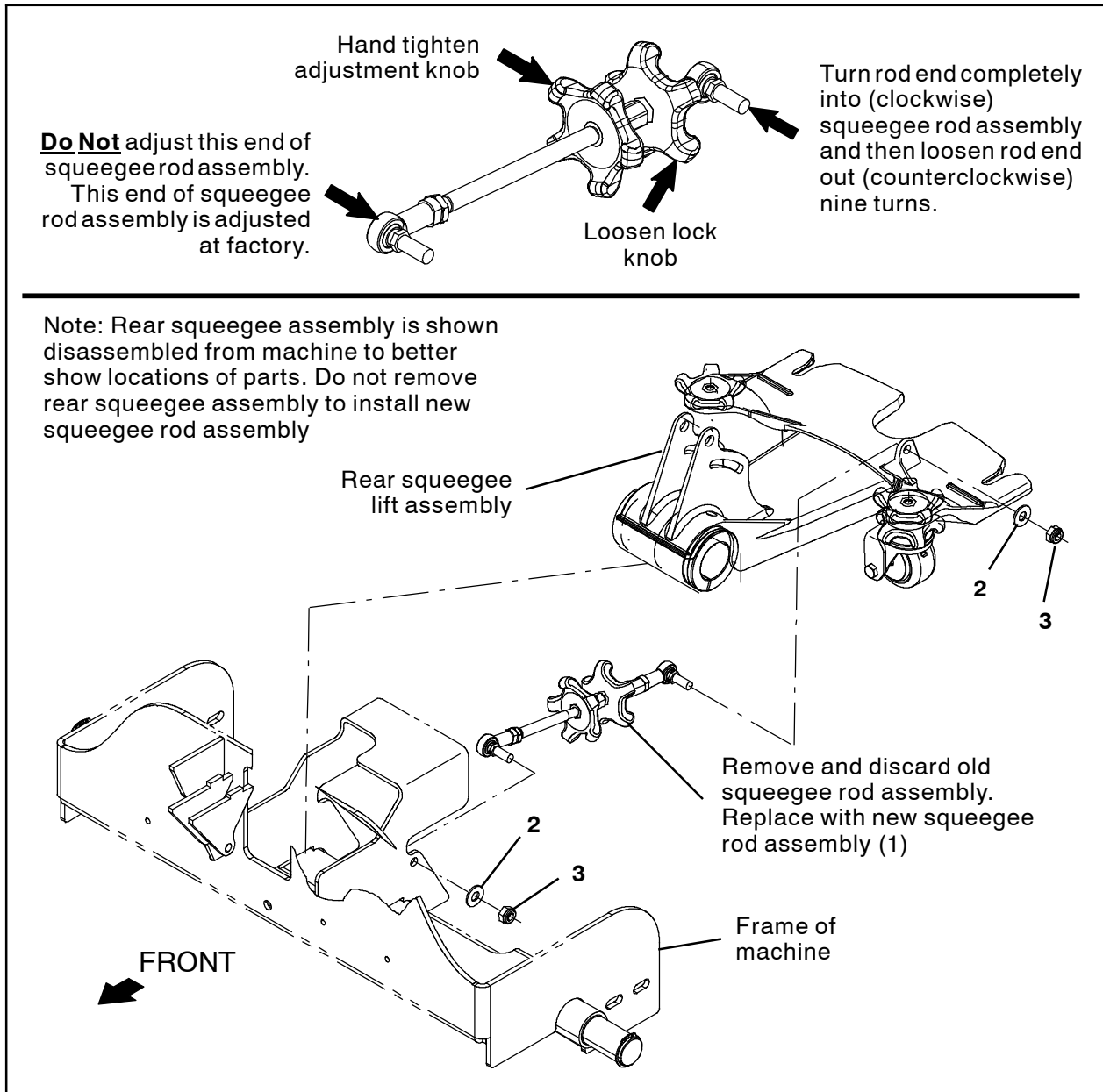

FIG. 1

Bill Of Materials For Turnbuckle Replmt, Afmkt [T12] - 9010937

Ref.	Tennant Part No.	Description	Qty.
▽	9010937	Turnbuckle Replmt, Afmkt [T12]	1
▲	1 1202643	Rod Assy, Squeegee	1
▲	2 01686	Washer, Flat, 0.44B 1.00D .08, SS	2
▲	3 08714	Nut, Hex, Lock, M10 X 1.5, NL, SS	2

TENNANT COMPANY  
P. O. Box 1452  
Minneapolis, MN 55440-1452